



sargent &  
greenleaf™



Atlas Electronic Safe Lock

Model 1004

## S&G Atlas Electronic Safe Lock Model 1004

**AN AFFORDABLE, PURPOSE-BUILT LOCK FROM THE MOST TRUSTED NAME IN SECURITY.**



Choose the expertise and excellence that governments, banks, and businesses worldwide have trusted for more than 150 years. **Protect your safe with Sargent & Greenleaf's two-user Atlas Electronic Safe lock Model 1004.**

### FEATURES:

- **HIGH SECURITY:** The AutoSecure lock withstands extreme pressure and delivers fail-safe security.
- **RELIABLE PERFORMANCE:** The Atlas lock delivers durability for the long haul, reducing the risk of costly repairs and the hassle of frequent maintenance.
- Updated tooling and cutting-edge manufacturing insure long-lasting, reliable protection.
- Redesigned, reengineered and tested to a minimum of 10,000 cycles.
- **STRESS-FREE WARRANTY:** We stand behind the construction and functionality of the Atlas lock with a one-year warranty.
- **SIMPLE INSTALLATION:** The Atlas lock fits the standard Sargent & Greenleaf Magic Module footprint, is field programmable, and is universally handed for easy right hand, left hand, vertical up, or vertical down mounting.

Learn more at [www.sargentandgreenleaf.com](http://www.sargentandgreenleaf.com).

Protecting assets from high-security government sites to banks to businesses for more than 150 years, Sargent & Greenleaf continues to set the standard for innovation, security, quality, and trust.

## TRUSTED SECURITY AND RELIABLE PERFORMANCE

Sargent & Greenleaf's Atlas Electronic Safe Lock Model 1004 delivers the performance and security you expect in a user-friendly two-user format.

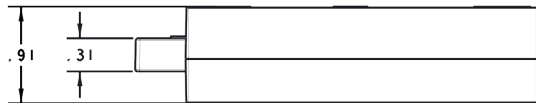
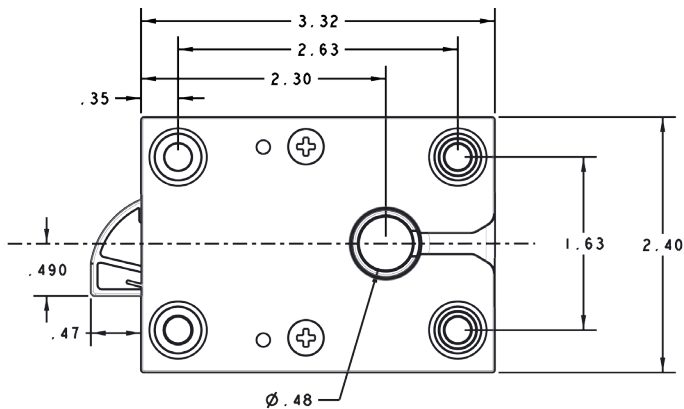

## PART NUMBERS

1004-101C	Bulk Locks (US)
1004-101M	Bulk Locks (Metric)
6120-272	Bright Chrome Bulk Keypads
6120-274	Black Platinum Bulk Keypads
6120-276	Matte Black Bulk Keypads

[www.sargentandgreenleaf.com](http://www.sargentandgreenleaf.com)

Corporate Headquarters: One Security Drive • Nicholasville, Kentucky 40356 • USA • Tel. 859-885-9411, Fax 859-887-2057

Except as otherwise noted, all trademarks in this data sheet are trademarks of Sargent and Greenleaf in the U.S. and elsewhere. ® denotes a trademark registered with the U.S. Patent and Trademark Office and/or other Trademark offices around the world.

Patents Pending.

## CERTIFICATIONS

- UL Type 1

## SPECIFICATIONS

### CODES

- One master code
- One user code
- One million codes to choose from
- Field programmable from keypad

## INSTALLATION

- Easily mounted Quickmount keypad
- Universally handed
- Standard S & G Magic Module footprint

## OPERATION

- Choose STAR or Basic operating procedures
- Penalty lockout after five failed attempts
- Tested up to 3,000 openings on a single 9-volt alkaline battery
- Low battery signal

## SPINBLOCKER LOCK

- AutoSecure, automatic secure mechanism
- Automatically locks when boltwork fully extended
- Lock bolt withstands 225 lbs (1000 newtons) of bolt end pressure
- Compatible with a multitude of S&G keypads

## ADDITIONAL FEATURES

- Bright Chrome, Black Platinum or Matte Black keypad finishes
- Lighted Keypad
- 1-year warranty

